

IPW185ID3S-A1-PoE-PCT

18.5" color TFT, 1366 x 768 WXGA, All-in-One Multi-Touch Panel PC with Intel® Atom™ Dual Core N2600 Processor



Introduction

The AIS 18.5" inch (1366 x 768 WXGA) all-in-one multi-touch screen panel PC or all-in-one self-service kiosk is fully-integrated, Power over Ethernet (PoE), multi capacitive touch screen combines high-performance Intel® Atom™ Dual Core Processor N2600 1.60 GHz, and Projected Capacitive Touch (PCT or PCAP) Technology in industrial-grade LCD flat panels, with sleek and flat front surface industrial design. This PCT technology is a capacitance system that delivers sensitive and accurate dual-touch interactive experience. The AIS 18.5" all-in-one multi-touch panel computer specifically suited for use in healthcare self-service kiosk system, access control, room reservation, room scheduling, as well as various interactive digital signage applications.

Specifications

Display	
Display	18.5" diagonal, Active matrix TFT LCD
Aspect Ratio	16:9 (Widescreen)
Active/Area	409.8 (H) x 230.4 (V) mm
Native (Optimal) Resolution	1366 x 768 WXGA
Colors	16.7M (6bits+FRC)
Brightness (Typical)	LCD Panel: 250 nits PCT Touch: 225 nits
Contrast Ratio	1000:1
Viewing Angle	Horizontal: 170° Total Vertical: 160° Total
Touch Technology	Projected Capacitive
System Hardware	
Processor	Intel® Atom™ Dual Core Processor N2600 1.60 GHz
System Chipset	Intel® NM10 Express Chipset
System Memory	2GB DDR3 800/1066 MHz, up to 4GB

Features and Benefits

- Integrated high performance CPU, RAM, data storage, USB 3.0, RS232, camera, and Ethernet ports
- Optional features: Smart Card, Barcode, or RFID Readers
- Unleash the power of your network with Power Over Ethernet (POE)
- Flexible, reliable, and ruggedized touch screen PCs for self-service kiosks
- Two independent touch points (with Windows 7 OS)

Storage	32GB SATA SSD
I/O Interfaces	
Serial Ports	1 x RS232
USB Ports	3 x USB 2.0 and 1 x USB 3.0
Ethernet Ports	1 x RJ 45-10/100/1000 Mbps (PoE)
VGA Port	1 x VGA
HDMI Port	1 x HDMI (optional feature)
Environmental Conditions	
Temperature	Operating: 0°C to 50°C (32°F to 122°F) Storage: -20°C to 60°C (-4°F to 140°F)
Humidity (Non-condensing)	30 to 90% RH @ 40° C
Vibration Protection	5 to 500 Hz, 1 Grms random vibration
General	
Power Input	12V DC Terminal Block (Phoenix Type)
Power over Ethernet or POE	3 x USB 2.0 and 1 x USB 3.0
Mounting Options	75 x 75 or 100 x 100 mm VESA Mount
Dimensions (W x H x D)	467 x 304 x 35 mm
Approvals	
Approvals	CE, FCC (DOC)

Order Information

IPW185ID3S-A1-PoE-PCT: 18.5" PoE Widescreen Multi-Touch Panel PC with Intel® Atom™ Dual Core N2600 Processor, 1366 x 768 WXGA, 1000:1 contrast ratio

Unit: mm

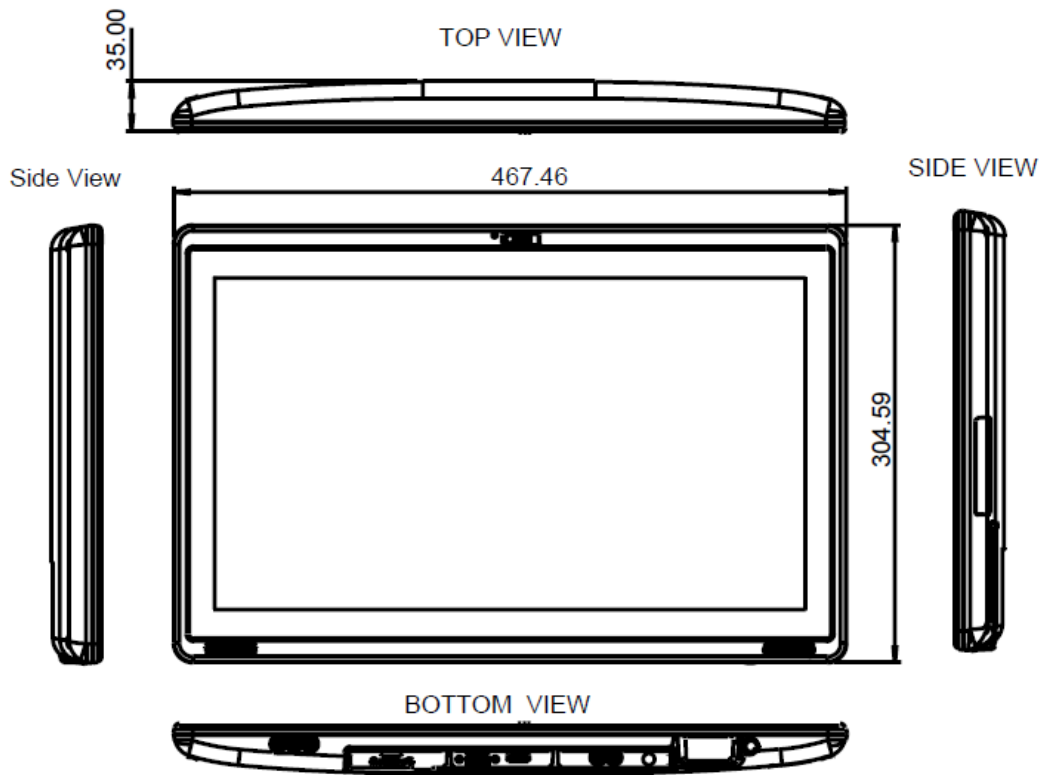

BACK VIEW

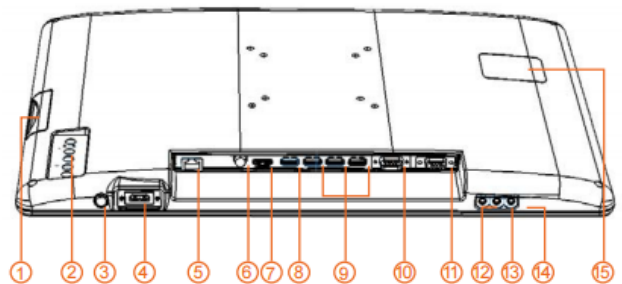
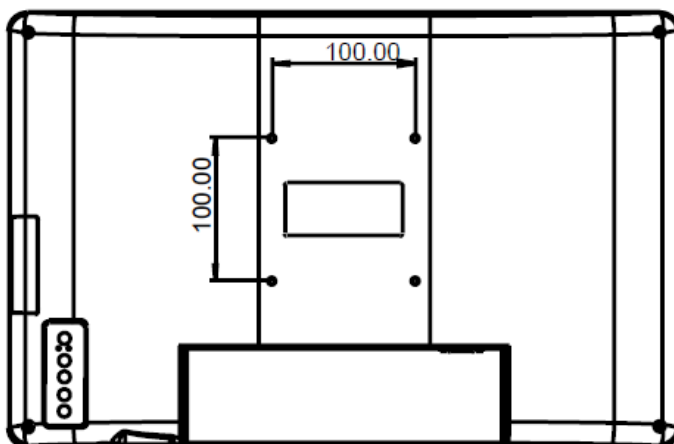

- | | | |
|---------------------------------|--------------------|----------------------------|
| 1. Smart Card Reader (optional) | 5. RJ45 | 11. VGA output |
| 2. Functionkey: Power On/Off | 6. DC 12V in | 12. Mic in |
| 3. Screen On/Off | 7. HDMI output | 13. Line in |
| 4. BarcodeReader (Optional)/ | 8. USB 3.0 | 14. Line out |
| HDMI Input (Optional) | 9. USB 2.0 | 15. RFID Reader (Optional) |
| | 10. Rs232 COM Port | |